

REVISIONS				
CHANGE ORDER	LTR	DESCRIPTION	DATE	APPROVED
Q08023	1	PAG 46 was PAG 100, added QP-H100 spec	08/26/08	
Q09035	2	ADDED TOLERANCES & PART NO'S	10/27/09	
ENG	3	QP16-1000M WAS QP16-1115	10/28/10	
Q11002	4	RELOCATED PRV	03/17/11	

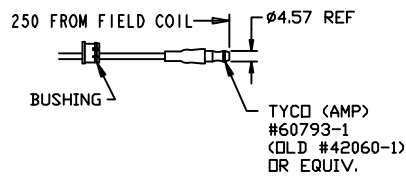

TERMINAL LEAD DETAIL

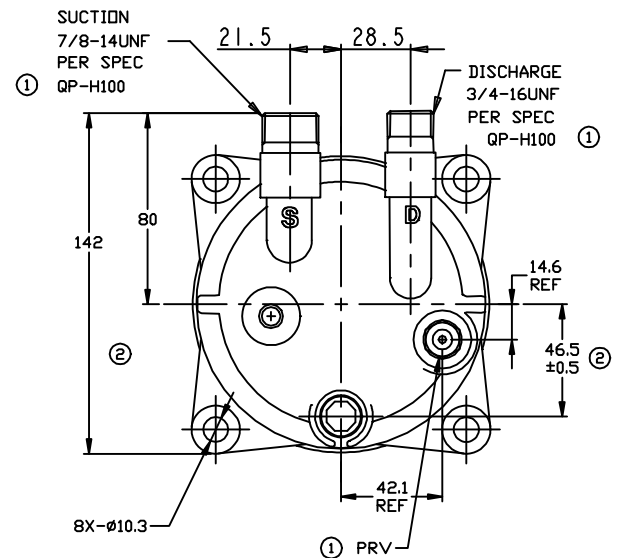
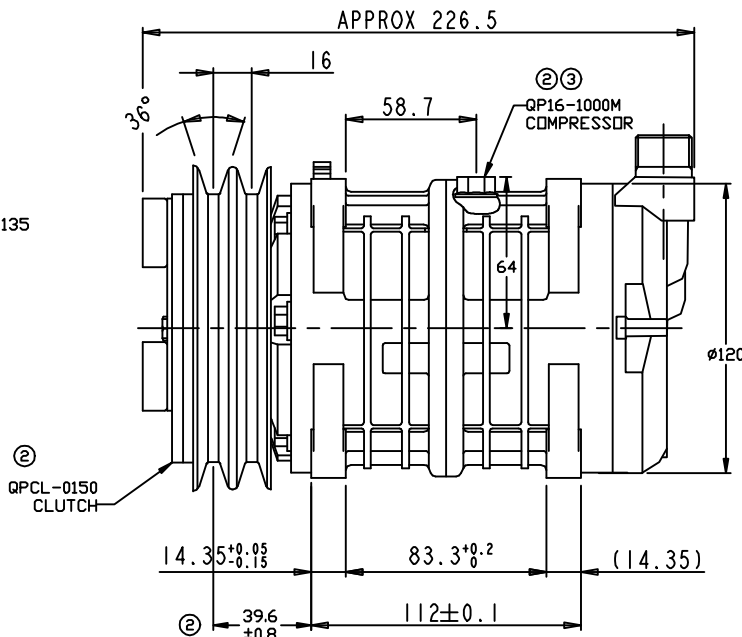
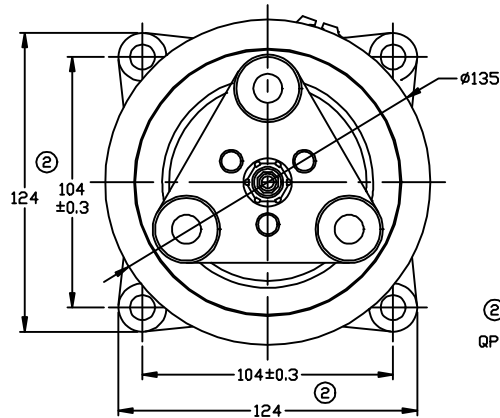

CLUTCH SPECIFICATIONS:

- VOLTAGE.....24 VDC
- BELT.....A2
- STATIC TORQUE
INITIAL.....35 Nm (3.5 Kgfm)
AFTER BURNISHING.....49 Nm (5 Kgfm)
- MAX POWER CONSUMPTION.....4.5W @ 25°C
- ROTATION DIRECTION.....CW OR CCW
- WEIGHT.....2.25 Kg

COMPRESSOR SPECIFICATIONS:

- MODEL.....QP16HD
- NUMBER OF CYLINDERS.....6
- BORE X STROKE.....36 X 26.7 mm
- DISPLACEMENT.....162.9 cm³/REV
- SPEED RANGE.....700 - 6000 RPM
- ROTATION DIRECTION.....CW OR CCW
- REFRIGERANT.....R-134a
- LUBRICANT.....PAG 46 180+20cm3
- WEIGHT.....4.7 Kg

UNLESS OTHERWISE SPECIFIED DIMENSIONS ARE IN MM. INTERPRET DIM AND TOL PER ASME Y14.5M - 1994	CAD GENERATED DRAWING. DO NOT MANUALLY UPDATE		 DECATUR, ILLINOIS	
	THIRD ANGLE PROJECTION	DRAWN GLB DATE 11/08/07		
	CHECKED	SIZE A CODE IDENT NO DWG NO QP16-1189 SCALE NONE	REV 4 SHEET 1 OF 1	
	APPROVED			